



# SIGNO

4.5" B/W AND COLOUR VIDEO DOOR PHONE



## DESCRIPTION

The Signo 1740/1 video door phone is styled by the Citterio Design Studio in collaboration with Toan Nguyen.

It can receive electronic calls using a speaker located under the handset and is provided with a three-position potentiometer (mute - soft - loud) for adjusting the call volume.

A red indication appears on the front of the video door phone when it is muted.

Signo is provided with a special speaker which by emitting electromagnetic waves allows the users of special hearing aids to hear the door phone conversation.

The Signo key button is backlit (green)  to find it easily in the dark.

The three supplementary buttons can be used for the following functions: turning the staircase lights on, opening the secondary electric lock and for intercom calls.

The apartment unit is small - 225 (h) x 205 (w) x 50 (d).

The wiring system is simple.

The following versions are available: B/W with 4.5" flat screen (shiny white, high-tech grey and anthracite), and colour with 4" TFT display.

By choosing the right bracket available for Signo, the device can be fitted in any Urmet system, including analogue systems with coax cable, 2GO! simplified wiring systems and Ipvoice systems.

The bracket is fixed to the wall by means of four bolts and has a removable terminal board for easy wire connection. The bracket with button add-on provides other 6 buttons, a switch and two LEDs.

The LEDs (properly connected) indicate when the door has been left open and if a call has been routed to another device.

The switch can be used to reroute the same call.

By using a smart-looking stand, Signo is perfectly suitable to be arranged on a desk. It occupies little space and ensures simple use of the video door phone functions.

## 1740/1 - Signo B/W video door phone

### Specifications

- Power voltage: 16 ÷ 8.5 Vdc
- Working consumption: max 0.6 A
- Stand-by consumption: 0 A
- Working power: max 10 W
- Vertical frequency (CCIR version): 50 Hz ± 2 Hz
- Horizontal frequency (CCIR version): 15625 Hz ± 300 Hz
- Video signal: 1 Vpp 75 Ω nominal / 1 Vpp -6 dB minimum
- Kinescope: 4,5" flat
- Phosphorous: P45
- Screen size: 81 x 59 mm
- Vertical geometric distortion: 5% max
- Horizontal geometric distortion: 5% max
- Barrel geometric distortion: 10% max
- Brightness: 100cd/m<sup>2</sup> max setting
- Switch-on delay: 7 sec max
- Transmitting capsule: electret microphone
- Receiving capsule: speaker 45 Ω
- Button voltage: 24 Vrms max
- Button current: 1.2 Arms
- Working temperature range: -5° ÷ +50° C
- Max humidity: 90% RH

## 1740/40 - Signo CLR video door phone

### Specifications

- Power voltage: 16 ÷ 8.5 Vdc
- Working consumption: max 0.35 A
- Stand-by consumption: 0 A
- Working power: max 6.5 W
- Vertical frequency (CCIR version): 50 Hz ± 2 Hz
- Horizontal frequency (CCIR version): 15625 Hz ± 300 Hz
- Video signal: 1 Vpp 75 Ω nominal / 1 Vpp -6 dB minimum
- LCD: 4" back-lighted
- Screen size: 81 x 59 mm
- Resolution: 380 H x 250 V pixel
- Colour system: PAL
- Switch-on delay: 4 sec max
- Transmitting capsule: electret microphone
- Receiving capsule: speaker 45 Ω
- Button voltage: 24 Vrms max
- Button current: 1.2 Arms
- Working temperature range: -5° ÷ +50° C
- Max humidity: 90% RH

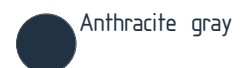



# SIGNO

## 4.5" B/W AND COLOUR VIDEO DOOR PHONE

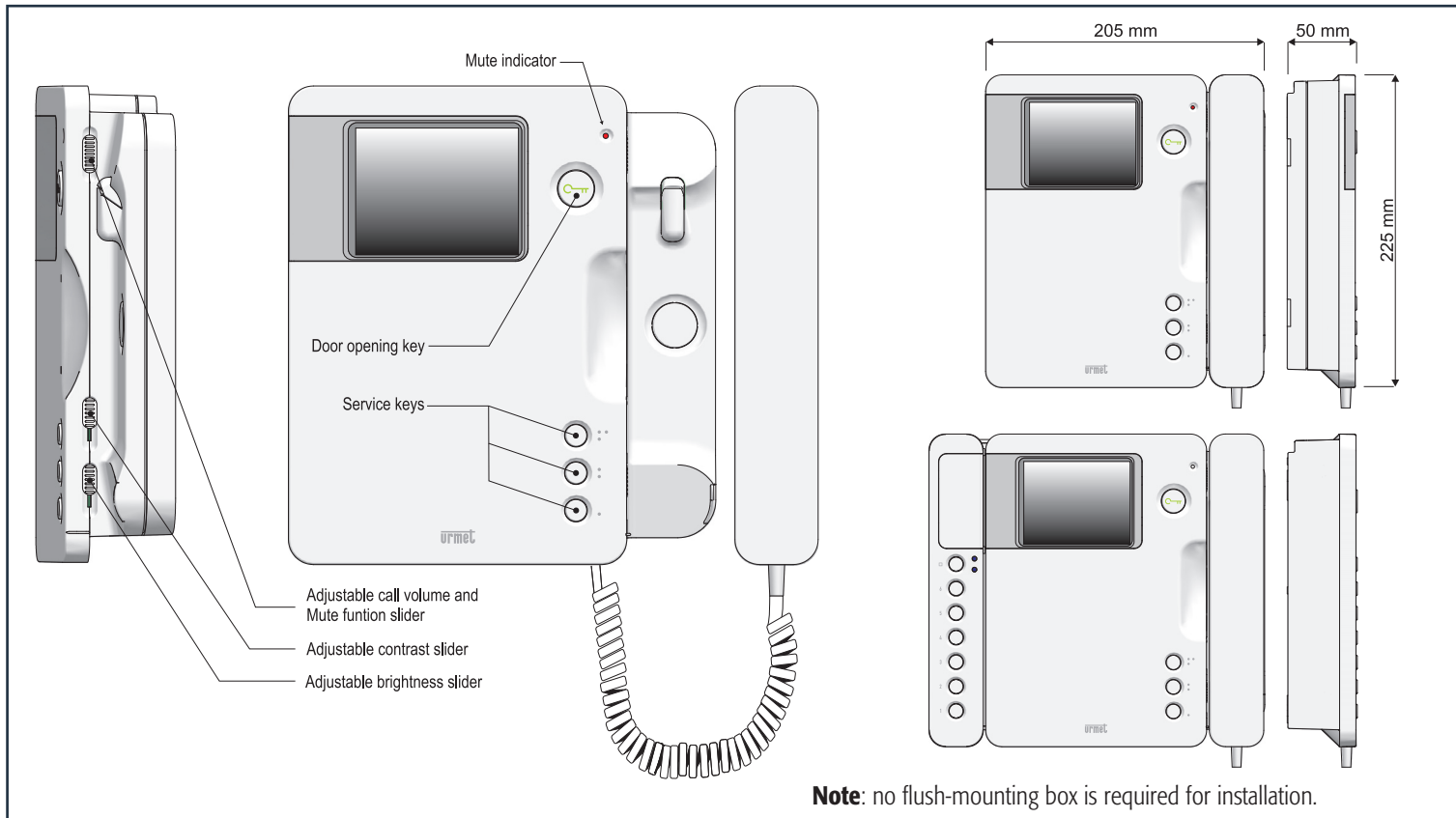

### Devices

- 1740/1 4.5" B/W video door phone
- 1740/40 4" COLOUR TFT video door phone
- 1740/41 4.5" B/W video door phone, anthracite
- 1740/42 4.5" B/W video door phone, high-tech grey

### Accessories

- 1740/86 Bracket with button add-on for coax systems
- 1740/90 Bracket for coax systems
- 1740/95 Bracket for Ipervoice system
- 1740/83 Bracket for 2Voice system
- 1740/954 Bracket for VOP system
- 1740/955 Bracket for 5-wire video system
- 1740/92 Table-top support
- 1740/93 Table-top support with additional monitor

### Spare parts

- 1740/101 Standard handset

- Door opening
- Function buttons
- Adjustable volume
- Adjustable brightness
- Adjustable contrast
- Hearing aids function

IMPORTANT NOTE: Urmel Domus S.p.A. reserves the right to change the features of the illustrated products without prior notice. This publication is not contractually binding.